

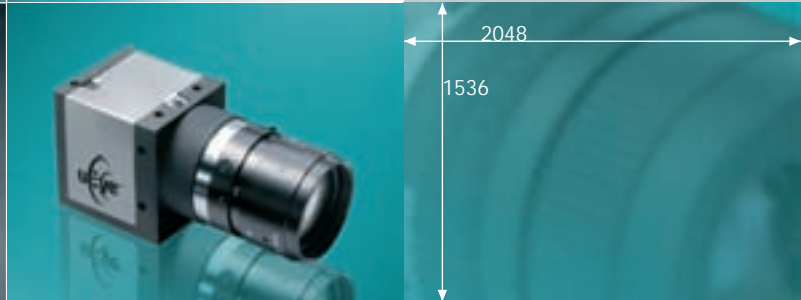

iDS



USB uEye[®] UI-1460SE-C

3,2 Mega pixels SUXGA Camera with 1/2" CMOS Sensor

USB uEye® UI-1460SE-C



The USB uEye® SE Family

The USB uEye® SE stands for a family of extremely compact, low-cost cameras for professional use in automation, quality assurance, security technology and non-industrial applications. Through the use of the widespread USB technology, the cameras can be interfaced with a vast variety of systems without any problems.

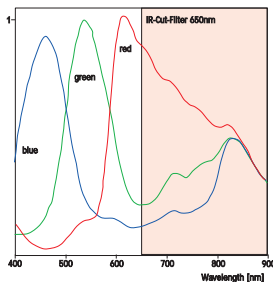

Sensor characteristics

UI-1460SE-C

Screw-mounted Micro Sub-D connector for USB, Trigger and Digital-Out

Conventional USB Mini-B connector

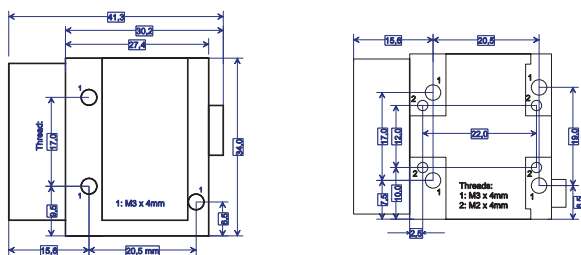
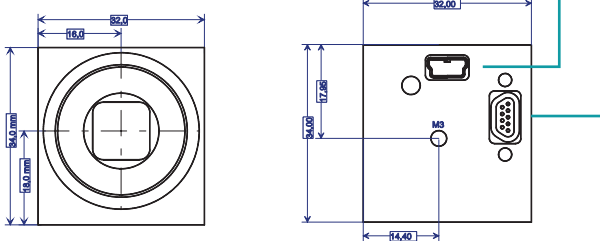

Dimensions: uEye® CMOS models

The characteristics at a glance

Interface	USB 2.0
Sensor Technology	CMOS
Model description (color)	-
Model description (Mono)	UI-1460SE-C
Resolution (h x v)	2048 x 1536
Resolution Category / Pixel Class	SUXGA/3,2 MP
Sensor size	1/2"
Shutter	Rolling
max. fps in Freerun Mode at full resolution	11,2 fps
max. fps in SW Trigger Mode at 1 ms exposure	11,2 fps
Exposuretime in Freerun Mode	57 µs - 1,74 s
Exposuretime in Trigger Mode	57 µs - 750 ms
AOI Modes	H ² + V ²
AOI with 1920 x 1080 Pixels	16,7 fps
Subsampling Modes	H ² + V ²
Subsampling Factors	2x, 3x, 4x, 5x, 6x, 8x
Resolution, fps	1024 x 768, 37,8 fps 640 x 480, 107 fps
Binning Modes	H ² + V ²
Binning Method	H: Summing V: Average
Binning Factors	2x, 3x, 4x, 6x
Mono: Maximum Gain	-
Color: Maximum Gain RGB/Master	7,25x/12,1x
Additional Gain Boost with Factor	2x
Sensor Model	MT9T001
Pixelpitch in µm	3,2
Optical Size	6,55 x 4,92 mm
Aspect Ratio	4:3
Exact Real Diagonal	8,2 mm, 1/2,0"

In scope of delivery:

Powerful, easy to handle uEye SDK
 uEye Demo and Programexamples executable and Source Code.
 uEye Camera Manager
 TWAIN, Active-X and Direct Show (WDM) drivers
 Interfaces for Activision Tools, Common Vision Blox, HALCON, LabVIEW and Neurocheck
 GenICam™ Interface

Driver for Windows 2000, XP, VISTA and Linux

² = Use increases frame rate

